

## Teacher's Information Pack

### School Visits: Collection Highlights



Explore six treasures of the national collection, through engaging discussions with our expert guides. Focusing on dialogue, questioning and creativity the visit will embolden students to look, respond and form opinions.

Before or after your visit you may wish to explore our [rich bank of schools resources](#) for tailored information, hi res images, activity ideas and lesson plans.

You will visit and explore the following works:

- [Diana Copperwhite, Shapeshifter, 2016](#)
- [Caravaggio, The Taking of Christ, 1602](#)
- [Johannes Vermeer, Woman Writing a Letter, with her Maid, c.1670](#)
- [Joshua Reynolds, Portrait of Charles Coote, 1st Earl of Bellamont \(1738-1800\), in Robes of the Order of the Bath, 1773-4](#)
- [Daniel Maclise, The Marriage of Strongbow & Aoife, c.1854](#)
- [Joseph Walsh, Magnus Modus, 2017](#)

It goes without saying that the safety of our staff, guides, school groups and other visitors to the Gallery is the number one priority. **Please read this information carefully before your visit so you can help us all stay safe.**

**Please be aware of the following visit procedures:**

- Face coverings are mandatory in the Gallery and Gallery Shop. Please refer to the government guidelines for more information.
- Please advise us in advance if any member of your group have learning difficulties, are hard of hearing or Deaf, and require our guides to wear a visor instead of a face covering
- Large school groups must be divided into six smaller 'pods' of five students, each accompanied by an adult.
- A member of the Education Team will greet you outside the Merrion Square Entrance.
- The team member will co-ordinate splitting the group into pods. Please allocate pods and adults ahead of your visit in order to help us.
- Each pod will be met by a Guide and taken to a set point in the Gallery (see route map)
- Temporary markings on the floor will indicate where the guide and the pod should stand, ensuring a 2m distance is maintained
- The pod will spend 5 minutes with the Guide learning about their first painting. After 5 minutes, each pod will rotate to the next stop (the Guides will remain in place).
- Each guide will direct the pod to the next guide
- At the end of the visit, the Guides will accompany their final pod to the Millennium Wing exit
- The school will be responsible for identifying a meeting point away from the Gallery to reconvene
- Please ensure your group listens to instructions from staff and follows the one way system at all times. This is for everyone's safety.

**Your route**

Staff and guides will direct you to each stop, via one-way arrows on the floor.

- Stop 1: Room 1 – [Diana Copperwhite, Shapeshifter, 2016](#)
- Take lift to Floor 3
- Stop 2: Room 25 – [Caravaggio, The Taking of Christ, 1602](#)
- Stop 3: Room 38 – [Johannes Vermeer, Woman Writing a Letter, with her Maid, c.1670](#)
- Stop 4: Grand Gallery – [Joshua Reynolds, Portrait of Charles Coote, 1st Earl of Bellamont \(1738-1800\), in Robes of the Order of the Bath, 1773-4](#)
- Take stairs to Shaw Room (or lift if needed for accessibility reasons)
- Stop 5: Room 22 – [Daniel Maclise, The Marriage of Strongbow & Aoife, c.1854](#)
- Stop 6: Courtyard – [Joseph Walsh, Magnus Modus, 2017](#)

# 1



### Rooms

- 1-5 European Art 1850-1950
- 5A Millennium Wing Studio
- 6-10 Temporary exhibitions
- 11 Library & Archive Gallery
- 14 Jack B. Yeats
- 14-19 Irish Art 1885-1965
- 20 Irish Stained Glass
- 21 Irish Art 1660-1835

### Wings

- Box Wing
- Atrium (12)
- Dargan Wing
- Millennium Wing
- Milltown Wing
- Courtyard (12A)

Floor 3 route map.psd @ 200% (Layer 1, RGB/8#)

# 3

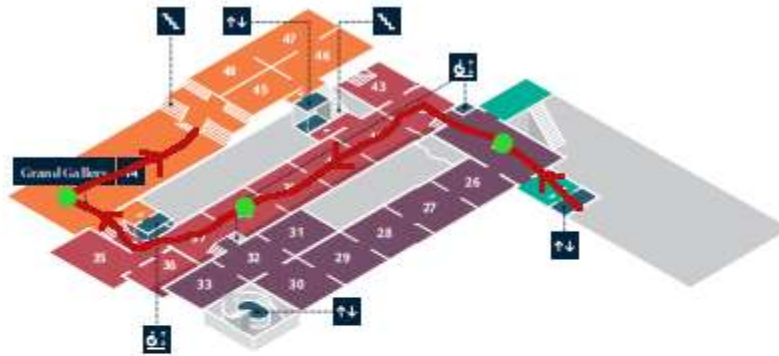

### Rooms

- 31 Hugh Lane Room (Temporary Exhibitions)
- 25-33 European Art 1300-1650
- 35 Members' Room
- 36 Temporary exhibitions
- 37-43 European Art 1600-1700
- 44 Grand Gallery
- 44-48 European Art 1700-1850

### Wings

- Box Wing
- Dargan Wing
- Milltown Wing

### Collection Highlights

			
● Room 30 Perugino The Conversation over the Dead Christ	● Room 37 Rembrandt and Conde approach the Alt on the Right side of the Alt	● Room 38 Vermeer Woman Writing at a desk with her hand	● Room 41 Caravaggio The Taking of Christ

### **Contact tracing**

In the event of an outbreak of COVID-19 in the Gallery, the Gallery is obliged, under HSE guidelines, to share the following information with the HSE for contact tracing purposes:

- your name
- the number of guests (tickets) in your party
- a telephone number
- the date of your visit

This information may be shared with the HSE for up to 30 days following your visit. Please note that no other information will be shared by the Gallery with the HSE.

Please do not visit the Gallery if any of the following apply to you:

- If you are feeling unwell or are experiencing any symptoms of COVID-19
- If you are awaiting the results of a COVID-19 test
- If you are self-isolating or restricting your movements
- If you have been diagnosed with confirmed COVID-19 infection in the last 10 days
- If you are a close contact of a person who is a confirmed case COVID-19 in the past 14 days (i.e. less than 2m for more than 15 minutes), or of someone who is awaiting a test result
- If a doctor has advised you to isolate or cocoon
- If you have returned from international travel and are not in compliance with government guidance

### **If you feel ill while in the Gallery**

Please ensure that you are wearing your mask, and notify a Museum Security Officer (MSO) while keeping a 2-metre distance from other visitors and staff. The MSO will contact a Gallery First Aid Responder who will bring you to an isolation room for assessment.

### **Hand sanitiser**

Please use the hand sanitiser, which is available at the entrance and exit, and throughout the Gallery.

### **Social distancing**

Please follow the directions of our staff, observe social distancing guidelines, and respect any maximum capacity signage that you see.